

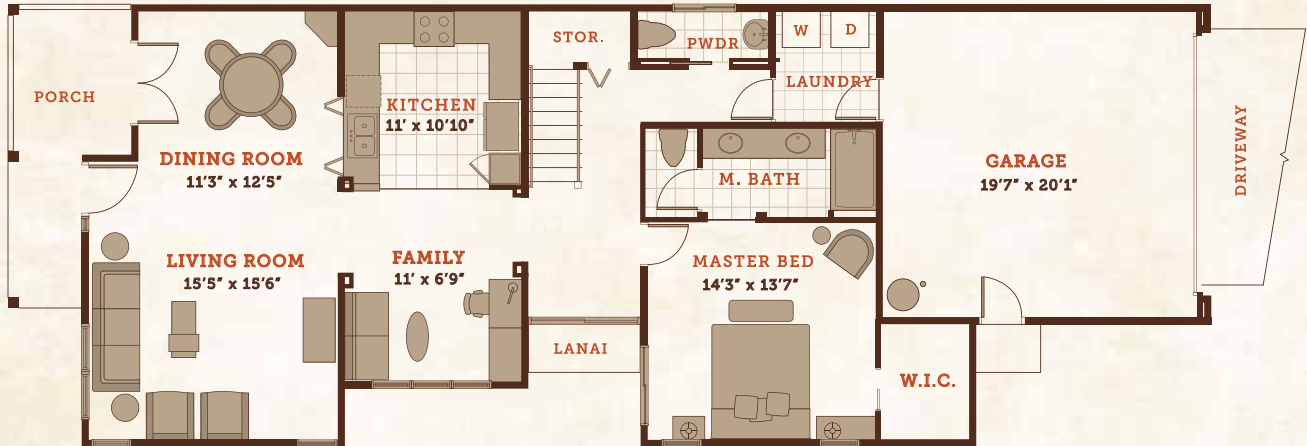

KAHOMA VILLAGE

--- Kawailani (Plan 7) ---

FIRST FLOOR



SECOND FLOOR

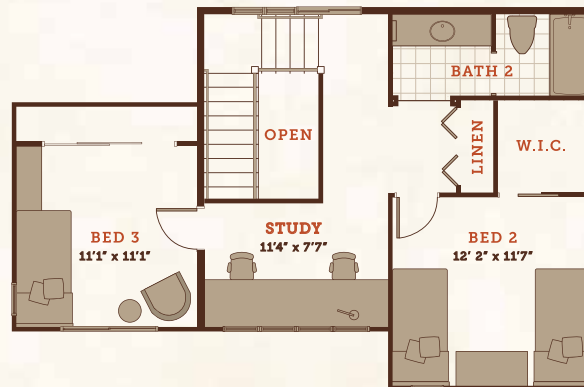

- 3 Bedroom
- 2.5 Bath
- 2 Story

- Living Area: 1,779 sq. ft.
- Garage: 371 sq. ft.
- Porch: 117 sq. ft.

Exterior Architecture Styles:

- Plantation
- Cottage
- Craftsman

--- FEATURES ---

- Large entry porch
- Granite countertops in kitchen
- French doors in dining room
- Large study area on second floor
- Master bedroom on the first floor
- Separate toilet room in master bath
- Walk-in closet in master bedroom
- Double lavatories in master bath
- Quartzite countertops in bathrooms
- Cast iron tub/shower
- Porcelain panel with wainscot accent band in bath
- Mirrored closet doors
- Laundry room
- 9' ceilings on 1st floor and 8' ceilings on 2nd floor
- Side door in garage
- Fenced yard
- 80 gallon solar water heater
- Ceiling fan junction boxes in all bedrooms and living room
- Optional split a/c system

© 2017 Kahoma Village. All rights reserved. | www.kahomavillage.com | T: 808.661.0002 | F: 888.673.0241 | info@kahomavillage.com

This is an artist's depiction of Developer's current proposed development concepts for the Project, which concepts continue to evolve and are subject to change without notice. All dimensions and square footage calculations are approximate and subject to change. Furnishings are represented for illustration purposes only. Units are not furnished. Any renderings, photos, drawings or other representations as to units or other elements of the Project that are delivered or shown to prospective purchasers may not accurately portray such units and other elements, and do not constitute a representation by Developer. Prices are subject to change without notice.